

RETRACTAWAY 40 & 50 Installation Instructions

Installation options:

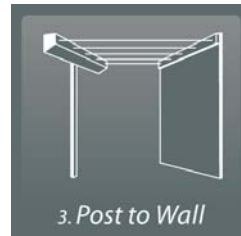

For (1) Wall to Wall installation see below.

For (2) Wall to Post installation see Page 2.

For (3) Post to Wall installation see Page 3.

For (4) Post to Post installation see Page 4.

For Line Adjustment see Page 2 & 3.

For Ground Socket installation see Page 4 – this is for a Removable Post installation only.

PLEASE NOTE:

- The maximum distance between the 2 mounting points
 - i. should not exceed 8 meters for the RetractAway 40
 - ii. should not exceed 10 metres for the RetractAway 50
- Cabinet fixings are not supplied. Fixing bolts are supplied with Mounting Bar and RetractAway Post.
- Both RetractAway models may be used over shorter distances without impeding function.
- Ensure there is a minimum of 1m clearance to each side of the lines to allow washing to blow freely.

Select your preferred installation option and follow the appropriate instructions.

(1) WALL TO WALL

You will need:

1 x RetractAway Cabinet

For masonry fixing: 4 x 8mm masonry anchors (not supplied)

For timber fixing: 4 x 8mm coach screws (not supplied). Ensure timber walls have adequate internal support.

Position the RetractAway Cabinet on the wall so the side slots rest against the wall and are approximately 50mm above user's head height. Install at 1800mm above finished ground level for general installations.

Mark the wall through the slots on each end.

Drill 2 holes to suit purchased fasteners. Fit the RetractAway Cabinet to the wall ensuring the 8mm washers (supplied) are positioned over the Cabinet side slots but under the fastener heads. DO NOT OVERTIGHTEN the fasteners. You need only ensure they are firm. NOTE: A RetractAway Mounting Bar may be required if fixing the Cabinet to an uneven surface. This will ensure the fixing points are not unduly stressed.

Position the Receiving Bracket (at right) against the opposite wall at the correct height and centre to the Cabinet. Mark and drill the 2 holes. Secure the Receiving Bracket with remaining fasteners ensuring the Catch is positioned as in picture at right. This will hold the Receiving Arm securely in place when extended.

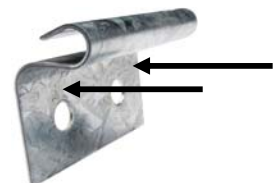

Tension the cord lines according to the instructions below.

RETRACTAWAY LINE ADJUSTMENT – Required for all installation options

DO NOT ADJUST LINES FOR 48 HOURS IF USING A POST INSTALLATION (Allow cement to cure).

Extend the lines to the receiving wall/post and hook into place. Lock the Cabinet into place using the Lock/Unlock Clip. This is easily done by turning the Tension Knob (black knob with white centre) clockwise a few millimeters and pushing the Lock/Unlock Clip into position.

The lines are tensioned from the receiving end (the opposite end to the Cabinet).

Fig. 1 Commence with the centre line. Slide the 6mm black Cord Tidy towards the Cabinet to release the end of the line.

Fig. 2 Unwind the cord from the top and bottom of the cord tension lock until the end of the line is exiting from the same point as the main line (Fig. 3)

Fig. 4 Gently pull the end of the line towards the Cabinet to take up any slack in the line. Do not pull too tightly as this will make the other lines uneven. All lines should be similar in tightness.

Fig. 5 Rewind the cord back onto the line tension lock. Slide the black cord tidy back over the end of the line and push the cord tidy firmly towards the Receiving Arm end to lock cord in place.

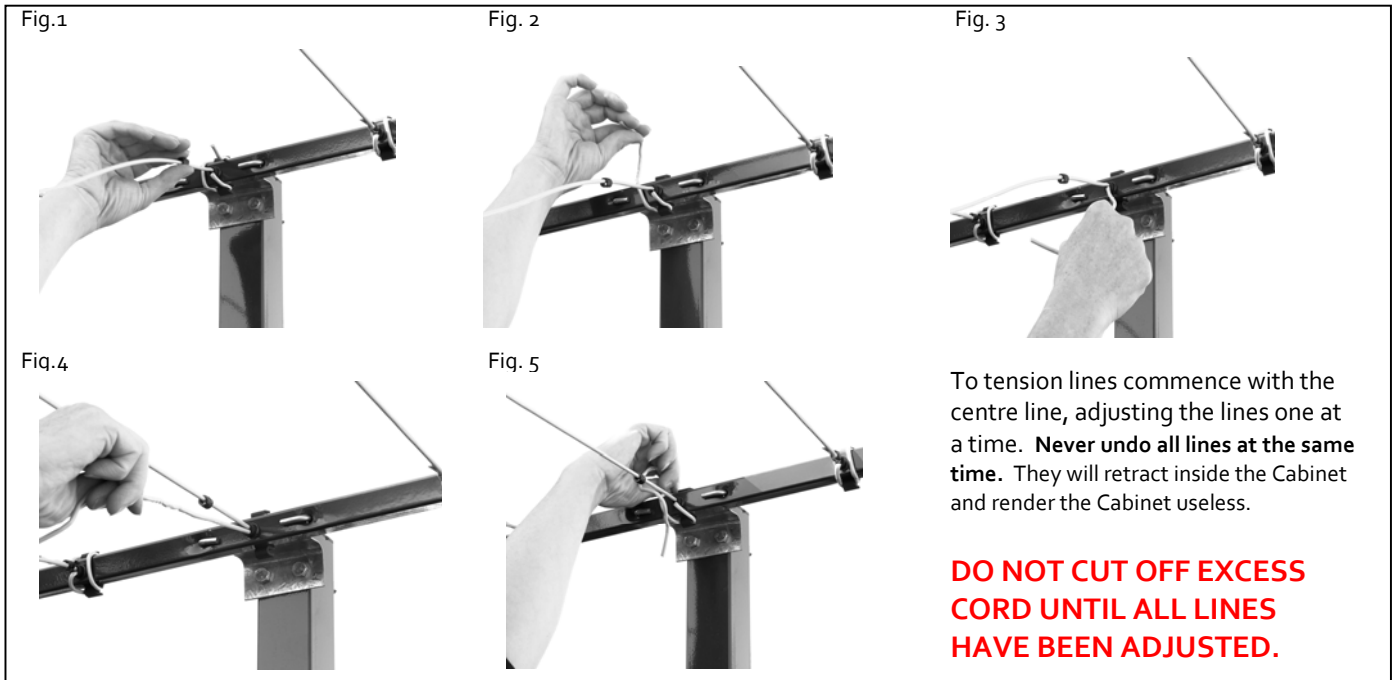

Tension the required lines **one at a time** according to the method above until all lines are similar in tension. Cut off any excess cord leaving about 10-20mm past the cord tidy. The Tension Knob (black and white knob) should only be used to tighten the lines after initial tensioning has been completed. Use of the Tension Knob only will not result in the even adjustment of all lines. **DO NOT FORCE THE TENSION KNOB** to achieve additional adjustment. The lines are PVC cord and will retain a little flexibility even when fully tensioned.

Fix the Cabinet at the appropriate height as the Austral RetractAway will not allow lines to sag once installed.

RetractAway Cabinets have considerable pull-out force and care should be taken whenever using the Cabinet.

NOTE: DO NOT ALLOW THE RETRACTAWAY ARM TO RETURN UNASSISTED TO THE CABINET.

DO NOT REMOVE THE SIDES OF THE CABINET UNDER ANY CIRCUMSTANCES.

Removal of either side may release the internal tension mechanism which will stop the unit from retracting. This will void the Warranty.

TO RETRACT THE RECEIVING ARM

From the Cabinet end, move the clip to the Unlock position. Walk to the opposite end and stand under the RetractAway Arm. Place your hands on the Arm – either side of the Bracket and carefully unhook the Arm. Hold the Arm firmly and **walk** the Arm back towards the Cabinet. **DO NOT ALLOW THE ARM TO RETRACT UNASSISTED.** Walking slowly towards the Cabinet will ensure the lines retract easily and evenly. Slide the Arm back into position inside the RetractAway Cabinet.

(2) WALL TO POST

You will need:

1 x RetractAway Cabinet

1 x RetractAway Post

1 x Ground Socket (optional accessory if Post is to be removable)

For masonry fixing: 2 x 8mm masonry anchors (Not supplied)

For timber fixing: 2 x 8mm coach screws (Not supplied) Ensure timber walls have adequate internal support.

For cement: Gravel, sand and cement or pre-mixed fast setting cement.

The maximum distance

- should not exceed 8 meters for the RetractAway 40
- should not exceed 10metres for the RetractAway 50

Mount the Cabinet to the wall according to the instructions in (1) Wall to Wall on page 1. Mark the position for the receiving Post.

NOTE: The Post may be installed at any distance less than 8m (or 10m) but not more than 8m (or 10m). Mark the centre of the hole.

NOTE: If Post is to be removable please refer to Ground Socket installation on Page 4.

Bolt the Receiving Bracket to the Post using fixings supplied. Dig a hole 700mm deep and 250mm in diameter. Place 200mm of gravel ONLY in the hole and stand the Post on top of the gravel. Test the height of the Receiving Bracket – this should be the same height as the RetractAway Cabinet. You can adjust the height by adding or removing gravel.

Mix the concrete in following proportions – 3 gravel:1 sand:1 cement or use premixed fast setting cement according to manufacturer's instructions. Concrete should be damp enough to hold together when squeezed in the hand. Hold the Post upright and ensure the Receiving Bracket is facing the Cabinet. Fill the hole halfway with concrete and tamp down with a rod to settle the concrete. Check the Post is perpendicular. Fill the hole and repeat to settle the concrete. Ensure the Post is perpendicular and the Receiving Bracket is facing the Cabinet. Finish off with fine cement and LEAVE FOR 48 HOURS.

DO NOT TENSION LINES UNTIL CEMENT HAS CURED. Tension the cord lines according to the Line Adjustment instructions on Pages 1 & 2.

(3) POST TO WALL

You will need:

1 x RetractAway Cabinet

1 X Mounting Bar

1 x RetractAway Post

1 x Ground Socket (optional accessory if Post is to be removable)

For masonry fixing: 2 x 8mm masonry anchors (Not supplied)

For timber fixing: 2 x 8mm coach screws (Not supplied). Ensure timber walls have adequate internal support.

For cement: Gravel, sand and cement or pre-mixed fast setting cement.

The maximum distance

- should not exceed 8 meters for the RetractAway 40
- should not exceed 10metres for the RetractAway 50

NOTE: The Post may be installed at any distance less than 8m (or 10m) but not more than 8m (or 10m). Mark the centre of the hole.

Fit the Mounting Bar to the Post using the fixings supplied. Attach the Cabinet to the Mounting Bar using the bolts provided. Be sure to position a washer between the head of the bolt and the slots on the Cabinet. DO NOT OVERTIGHTEN.

Select a suitable site and install the Post by digging a hole 700mm deep and 250mm in diameter. Place 200mm of gravel ONLY in the hole and stand the Post on top of the gravel. Check the Cabinet height. The slots where the Cabinet is bolted to the Post should be approximately 50mm above the user's head height. If Post is to be removable please refer to the Ground Socket installation on Page 4.

Mix the concrete in following proportions – 3 gravel: 1 sand: 1 cement or use premixed fast setting cement according to manufacturer's instructions. Concrete should be damp enough to hold together when squeezed in the hand. Hold the Post upright and ensure the Cabinet is facing the correct way. Fill the hole halfway with concrete and tamp down with a rod to settle the concrete. Check the Post is perpendicular. Fill the hole and repeat to settle the concrete. Ensure the Post is perpendicular and the Cabinet is facing the correct way. Finish off with fine cement and LEAVE FOR 48 HOURS.

Position the Receiving Bracket against the wall and mark the two holes to be drilled. Ensure the Receiving Bracket is at the correct height and centre to the Cabinet. Drill holes as marked and fit Bracket using suitable fasteners.

DO NOT TENSION LINES UNTIL CEMENT HAS CURED. Tension the cord lines according to the Line Adjustment instructions on Page 1.

(4) POST TO POST

You will need:

1 x RetractAway Cabinet

1 X Mounting Bar

2 x RetractAway Post

1 x Ground Socket (optional accessory if Post is to be removable)

For cement: Gravel, sand and cement or pre-mixed fast setting cement.

The maximum distance

- should not exceed 8 meters for the RetractAway 40
- should not exceed 10metres for the RetractAway 50
-

NOTE: The Post may be installed at any distance less than 8m (or 10m) but not more than 8m (or 10m). Mark the centre of the hole.

Fit the Mounting Bar to a Post using the fixings supplied. DO NOT OVERTIGHTEN. Later the Cabinet will be fixed to this Post.

Select a suitable site and install the Post by digging a hole 700mm deep and 250mm in diameter. Place 200mm of gravel in the hole and stand the Post on gravel and check height. The Mounting Bar should be approximately 50mm above the user's head height. For stability it is recommended the Post bearing the Cabinet remains permanently fixed. If using a Ground Socket please refer to the Ground Socket installation below.

Mix the concrete in following proportions – 3 gravel: 1 sand: 1 cement or use premixed fast setting cement according to manufacturer's instructions. Concrete should be damp enough to hold together when squeezed in the hand. Hold the Post upright and ensure the Mounting Bar is facing the second Post. Fill the hole halfway with concrete and tamp down with a rod to settle the concrete. Check the Post is perpendicular. Fill the hole and repeat to settle the concrete. Ensure the Post is perpendicular and the Mounting Bar is facing the correct way. Finish off with fine cement and LEAVE FOR 48 HOURS. Attach the Cabinet to the Mounting Bar using the bolts provided. Be sure to position a washer between the head of the bolt and over the slots on the Cabinet.

Fit the Receiving Bracket to the second Post using the fixings supplied. Dig a hole 700mm deep and 250mm in diameter. Place 200mm of gravel in the hole and stand the Post on top of the gravel. Check the height of the Receiving Bracket – this should be the same height as the Mounting Bar/RetractAway Cabinet. The height may be adjusted by adding or removing gravel. Ensure the Post and Receiving Bracket is centre to the Cabinet. Cement the second Post using the procedure above and then LEAVE FOR 48 HOURS.

DO NOT TENSION LINES UNTIL CEMENT HAS CURED. Tension the cord lines according to the Line Adjustment instructions on Pages 1 & 2.

Ground Socket Installation

A Ground Socket will allow for easy Post Removal. Dig a hole 600mm deep and 250mm in diameter. Fill with gravel until the top of the Ground Socket is level with the ground surface. Remove the socket from the hole.

Punch the Galvanized Pin through one of the 5 holes on the side of the Ground Socket to set the correct height for the Cabinet or Receiving Bracket according to the details below. The Post may be reduced in length if the height remains too high.

Starting from the top hole the height of the line will be:

Hole 1 - 2020mm

Hole 2 - 1970mm

Hole 3 - 1920mm

Hole 4 - 1870mm

Hole 5 - 1820mm

Select the desired setting and tap the Pin through the appropriate hole. Place the Ground Socket back in the hole and insert the Post. Fill hole with a further 50mm with gravel then add concrete mixed in the following proportions – 3 gravel: 1 sand: 1 cement or use premixed fast setting cement according to manufacturer's instructions. Concrete should be damp enough to hold together when squeezed in the hand. Ensure the Ground Socket and Post is square to the Cabinet and the Post is facing the correct way. Fill the hole halfway with concrete and tamp down with a rod to settle the concrete. Check the Post is perpendicular. Fill the hole and repeat to settle the concrete. Ensure the Post is perpendicular. Finish off with fine cement and LEAVE FOR 48 HOURS.

A piece of line cord may be attached to the Ground Socket Cap to allow the Cap to hang on the Cabinet or Post during line use. It will always be ready for use when the Post is removed.

Guarantee – State Contact Details

10 Year Structural Guarantee

Austral Clothes Hoists Pty. Ltd. guarantee the tubular frame from breakage caused from rust and distortion on all colour coated and Galvanized metal products for a period of 10 years given fair wear and tear. Misuse or incorrect adjustment will void this Guarantee.

12 Month Guarantee

Austral Clothes Hoists Pty. Ltd. guarantees to replace any defective part that fails to operate correctly due to faulty Workmanship or defective materials free of charge for a period of twelve months from date of purchase. Misuse or incorrect adjustment will void this Guarantee. Austral Clothes Hoists Pty. Ltd. will not be responsible for any costs arising from postage or freight charges or for labour charges incurred in the dismantling or re-assembling of the line.

Note:

Please contact your local Distributor below for your nearest stockist of spare parts and accessories.

VICTORIA/TASMANIA	(03) 97067577
NEW SOUTH WALES/ACT	(02) 99581533
SOUTH AUSTRALIA/ N.T.	(08) 83374445
QUEENSLAND	(07) 55924546
WESTERN AUSTRALIA	(08) 94551985